

# MOUNT CARDRONA STATION SPECIAL ZONE

12

**Note:** **Red** text (in **addition** and **deletion**) denotes changes suggested by the QLDC in 2012 as part of preparation for the District Plan review, and agreed to by Mount Cardrona Station Limited

**Blue** text (in **addition** and **deletion**) denotes new changes proposed by Mount Cardrona Station Limited.

**Green** text (in **addition**) denotes new changes proposed in further submissions by Mount Cardrona Station Limited

**Purple** text (in **addition**) denotes new changes proposed as part of the section 42A report

**Yellow Highlighted** text (in **addition** and **deletion**) denotes new changes proposed following receipt and review of the s.42A Report.

**Brown** text (in **addition** and **deletion**) denotes new changes proposed following the hearing.

**Turquoise highlighted** text (in **addition** and **deletion**) denotes new changes proposed in the recommendations made by the Commission

~~Cardrona Village, and approximately 20km to the south of the Wanaka township.~~

~~The Zone is configured in a manner that creates a high quality sustainable environment. It provides significant benefits to the wider community through the provision of recreational activities protection of open space, educational and community facilities, a range of housing options, sustainable infrastructure design, and the creation of a distinctive destination.~~

~~The preparation of site and zone standards in the District Plan and Design Guidelines will ensure that the Village contributes to the social, economic and cultural wellbeing of the wider community, contributing to the integration of the built and natural environment.~~

**Interpretation:**

It is noted that Activity Areas 1, 2, ~~3~~, 5, **6**, 7 and ~~6~~ **8** all contain sub-areas. Except where 'a' or 'b' **or 'c'** is specifically listed, the rules of the Activity Area shall apply. For example, Activity Area **31** contains two sub-activity areas **31a** and **31b**. Where a rule refers to Activity Area **31**, it applies to both Activity Areas **31a** and **31b**.

**12.22.21 District Rules**

Attention is drawn to the following District Wide Rules which may apply in addition to any relevant Zone rules. The provisions of the Mount Cardrona Station Special Zone will take precedence over the District Wide Rules in any situation where the rules differ. Otherwise the provisions of the District Wide Rules shall continue to apply.

- (i) Heritage Protection - Refer Part 13
- (ii) Transport - Refer Part 14
- (iii) Subdivision - Refer Part 15
- (iv) Hazardous Substances - Refer Part 16
- (v) Utilities - Refer Part 17
- (vi) Signs - Refer Part 18
- (vii) Relocated Buildings and Temporary Activities - Refer Part 19

**12.22.32 Activities**

## 12.22 Mount Cardrona Station Special Zone Rules

### 12.22.1 Zone purpose

~~The purpose of the Zone is to provide for an integrated community within a Village environment that provides a range of activities including visitor accommodation commercial, residential, educational and community activities. The Zone is located within the Cardrona Valley, 2km north of the existing~~

# MOUNT CARDRONA STATION SPECIAL ZONE

12

## 12.22.32.1 Permitted Activities

Any Activity which complies with all the relevant **Site** and **Zone** Standards and is not listed as a **Controlled, Discretionary, Non-Complying or Prohibited** Activity, shall be a **Permitted Activity**.

## 12.22.32.2 Controlled Activities

The following shall be **Controlled Activities** provided they are not listed as a **Prohibited, Non-Complying or Discretionary** Activity and they comply with all the relevant **Site** and **Zone** Standards.

The matters in respect of which the Council has reserved control are listed with each controlled activity.

### i. Educational facilities and community activities, including health and day care facilities, in Activity Areas 1, 2 and 3b and commercial recreation activities in Activity Area 5

Matters over which control is reserved:

- Site layout
- External appearance of buildings
- Parking, loading and access
- Location of outdoor activities
- **Access to open space areas for educational facilities**
- **Noise**

### ii. Visitor Accommodation in Activity Areas 1b and 2

Matters over which control is reserved:

- Parking and access, including bus and pedestrian access
- Noise
- Hours of operation of premises licensed for the sale of liquor associated with visitor accommodation.

### iii. Earthworks that are for the purposes of:

- Access roads

- Underground car parks
- Walkways
- [Construction and maintenance of the golf course and related ground works including access and irrigation storage and reticulation](#)
- Farm tracks and bridle paths
- Utilities
- Mitigatory earthworks as shown on Structure Plan D
- [Construction of buildings](#)

And that:

- exceed a volume of **200m<sup>3</sup>** per site (within a 12 month period); or
- expose an area of bare soil greater than **400m<sup>2</sup>** in area within that site (within a 12 month period) where the average depth is greater than 0.5m; or
- are undertaken within 7m of a water body.

~~Shall be a controlled activity.~~

Matters over which control is reserved:

- Sediment control
- Dust control
- Site rehabilitation and landscaping
- **Effects of golf course construction on natural landform**

### iv. Buildings within Activity Areas 1 and 5a

Matters over which control is reserved:

- External appearance including colours and materials;
- Site configuration and building orientation;
- Signage;
- Lighting;
- Landscaping;
- Consistency with the Mount Cardrona Station Design Guidelines (~~2008~~ 2017);
- Advice of the Design Review Board;
- Design and height of a landmark building in Activity Area 1a in terms of the building's relationship to ~~the a~~ Village [Green square](#) or public open space and surrounding buildings.
- Provision for parking.

# MOUNT CARDRONA STATION SPECIAL ZONE

12

## v. Earthworks and planting required by Structure Plan D: Mitigation Earthworks and Planting Plan

Matters over which control is reserved:

- Proposed plant species and bunding
- Consistency with Structure Plan D: Mitigation Earthworks and Planting Plan
- The use of plant species that are proven to grow locally.

## vi. Buildings within Activity Area 9 (for the purpose of golf course and driving range operations and maintenance) and Activity Area 8a

Matters over which control is reserved:

- External appearance
- Landscaping
- Access and parking

## vii. Premises Licensed for the Sale of Liquor within Activity Area 1

Premises licensed for the sale of liquor under the Sale of Liquor Act 1989, for the consumption of liquor on the premises between the hours of 11pm and 7am. Matters of control are reserved with respect to the scale of the activity, car parking, retention of amenity, noise and hours of operation. This rule shall not apply to the sale of liquor:

- To any person who is residing on the premises (temporarily or permanently)
- To any person who is present on the premises for the purpose of dining.

## ~~viii. Buildings and Structures associated with the erection and maintenance of a gondola within Activity Areas 6 and 7b that provides access from the Zone to the Cardrona Ski Area.~~

~~Matters over which control is reserved:~~

- ~~— Location including the extent to which the passenger lift system breaks the line and form of the landscape with special regard to skylines, ridges, hills and prominent slopes.~~
- ~~— External appearance, including materials, colours and light reflectance, including consistency with existing landscape features of which the gondola will form a part.~~

- ~~— Access and parking~~
- ~~— Sediment and erosion control; and~~
- ~~— Protection of the historic water races~~

## 12.22.32.3 Discretionary Activities

The following shall be **Discretionary Activities** provided they are not listed as a **Prohibited or Non-Complying** Activity and they comply with all the relevant Zone Standards. Any activity that does not comply with ~~the any~~ site standards shall be a restricted discretionary activity with the Council's discretion limited to the activity subject to the site standard.

- i. **Commercial activities** (excluding service stations) in Activity Areas 1b, 2, 3, and 5 and **Commercial Recreational Activities** in Activity Areas 2 and 3
- ii. **Visitor Accommodation** in Activity Areas 3 and 4
- iii. **Educational facilities and community activities** in Activity Areas 3 (except 3b), 4 and 5.
- iv. **Access Roads in Activity Areas 6 and 7 and Carparking** in Activity Areas 6a and 7, except:
  - Roads identified within ~~the~~ Structure Plan A.
  - Underground car parks.
  - ~~— Road access and parking associated with a gondola.~~
- v. **Buildings and Structures associated with the erection and maintenance of a gondola within** Activity Areas 6a, 6b and 7 that provides access from the Village **Precinct** Centre to the surrounding recreational activities.
- vi. **Take off and landing of aircraft (except for emergencies)** within Activity Area 5a.
- vii. **Buildings and structures within Activity Area 6a** that are for the following purposes:

Comment [DCL1]: 13/12 "s" deleted from Areas and removed bold to follow format of other rules

Comment [DCL2]: 14/12 changed to reflect changes to policy 4.9 and 4.10

# MOUNT CARDRONA STATION SPECIAL ZONE

12

- (a) ~~One~~ recycling Station (Activity Area 6a only)
- (b) ~~One~~ gas storage facilities (Activity Area 6a only)
- (c) Buildings located within 25 metres of the southern boundary of Activity Area 3, and that are less than 50m<sup>2</sup> in size. Tennis courts (Activity Areas 6a and 6b only).

viii. Within Activity Area 8c: carparking; earthworks for carparking formation and avoidance or mitigation of visual effects; and buildings that are for shuttle / ski area ticketing, bus shelters, ablution facilities and complementary ancillary commercial uses (limited to such as chain fitting services and coffee carts) and associated buildings.

The Council's discretion is restricted to the following matters:

- (a) Effects of carparking, associated buildings and mitigation earthworks and landscaping on landscape and visual amenity values when viewed from Activity Areas 1, 2, 3, 4, 5 and 6 within the Zone, or from the existing dwelling on Lot 6 LT 344432, or from the Cardrona Valley Road;
- (b) In relation to earthworks: sediment control, dust control, site rehabilitation, the sealing of the carpark, and landscaping.
- (c) Nature and scale of the complementary ancillary commercial uses and associated buildings

**Note: "ancillary commercial uses" includes activities such as chain fitting, coffee carts and other small scale activities that provide services to people utilising the transport-related purpose of the Activity Area.**

viii ix. Any:

- building (and associated roading, parking and other related and ancillary activities) for any purpose.
- permanent road.
- permanent infrastructure

proposed to be constructed prior to the subdivision to create the site(s) for that activity.

## 12.22.32.4 Non-complying Activities

The following shall be Non-Complying Activities provided that they are not listed as a Prohibited Activity. Any activity which is not listed as a Prohibited Activity and which does not comply with one or more of the relevant zone standards shall be a Non-Complying Activity.

### i. Buildings in Activity Areas ~~6a, 6b~~, 7, and 8 and 9

Except:

- Buildings in Activity Area ~~6a~~ approved pursuant to Rule ~~12.22.2.3(vii)~~ (vii)
- Historic equipment
- Bus shelters within Activity Area ~~6a~~ (permitted pursuant to Site Standard ~~12.22.5.1(viii)~~)
- Buildings within Activity ~~Areas 8a and 9~~ approved pursuant to ~~Controlled Activity~~ Rule ~~12.22.32.2(vi)~~ (vi).
- ~~One recycling station within Activity Area 6 approved pursuant to Rule 12.22.32.3(vi)(a)~~
- ~~One gas storage facility within Activity Area 6 approved pursuant to Rule 12.22.32.3(vii)(b)~~
- ~~Two buildings within the Indicative Education Precinct within Activity Area 6, approved pursuant to Rule 12.22.3.3(vii)(c)~~.
- Buildings and structures associated with the erection and maintenance of a gondola approved pursuant to Rule ~~12.22.32.2(vii)2.3(v)~~ (v).
- Buildings within Activity Area 8c approved pursuant to Rule ~~12.22.2.23(viii)~~ (viii).
- ~~Fencing for tennis courts which is over 2m in height in Activity Areas 6a and 6b~~

### ii. Commercial activities, including commercial recreational activities, in Activity Area 4.

### iii. Visitor Accommodation:

- Located within Activity Area 4
- Located within a secondary unit.

Comment [DCL3]: 13/12 strikethrough removed from "F"

Comment [DCL4]: 14/12 inserted "6" before "b" to refer to sub-areas in a consistent manner

# MOUNT CARDRONA STATION SPECIAL ZONE

12

## iv.ii. Service Stations

iv. **The construction of any building within the Zone** (except within Activity Area 8a or Activity Area 9 approved pursuant to Rule 12.22.2.2(vi)) prior to approval of subdivision consent that establishes public access easements throughout Activity Areas 6 and 7 that are in general accordance with the Mount Cardrona Station Walkways Plan (Structure Plan C).

## vi. Take off and landing of aircraft; except for

- Emergencies
- Take off and landing within Activity Area 5a approved pursuant to Rule 12.22.32.3(vii)

vi.ii. **Secondary Units in Activity Area 2(a)** on sections lots less than 230m<sup>2</sup>

vii. Any motorised vehicle activity on, or use of, the legal road at the south-east corner of the Zone in Activity Area 6c, linking to Pringles Creek Road

viii. Tennis courts, parking, or buildings and structures for recycling station or gas storage facilities in Activity Area 6c

## 12.22.32.5 Prohibited Activities

The following shall be **Prohibited Activities**

i. **Except** for a recycling station approved pursuant to Rule 12.22.32.3(viii): Panelbeating, spray painting, motor vehicle repair or dismantling, fibreglassing, sheet metal work, bottle or scrap storage, motorbody building or fish or meat processing or any activity requiring an Offensive Trade Licence under the Health Act 1956.

## ii. Planting of the following tree species:

- ~~Pinus radiata~~

- ~~• Pinus muricata~~
- ~~• Pinus contorta~~
- ~~• Pinus ponderosa~~
- ~~• Pinus sylvestris~~
- ~~• Pinus nigra~~
- ~~• Douglas Fir~~
- ~~• All Eucalyptus varieties~~

- Pine (Pinus radiata)
- Bishops Pine (Pinus muricata)
- Contorta or lodgepole pine (Pinus contorta)
- Ponderosa Pine (Pinus ponderosa)
- Scots pine (Pinus sylvestris)
- Corsican Pine (Pinus nigra)
- Douglas Fir (Pseudotsuga menziesii)
- Mountain Pine / Dwarf Mountain Pine (Pinus mugo)
- Maritime Pine (Pinus pinaster)
- European larch (Larix decidua)
- Sycamore
- Hawthorn
- Boxthorn

## iii. Factory farming, Forestry activities and Mining

## iv. Industrial Activities

v. **The installation of any domestic heating appliance that is designed to have the ability to burn coal**

## vi. Residential Flats

There shall be no residential flats constructed within the Mount Cardrona Station Special Zone. This rule does not apply to secondary units.

## vii. Buildings in Activity Area 7a

viii. **Residential Activities and Visitor Accommodation Activities in Activity Areas 5, 6, 7, and 8 and 9**

Comment [DCL5]: 13/12 full stops added after roman numerals vi. vii. and viii and 12.22.2.5(vi), (vii) and (viii)

Comment [DCL6]: 14/12 fixed cross-reference

# MOUNT CARDRONA STATION SPECIAL ZONE

# 12

## ix. Activity Area 7

- (a) Buildings, except:
- Buildings and structures associated with the erection and maintenance of a gondola approved pursuant to ~~Rule 12.22.3.3(v)~~ ~~12.22.2.2(viii)~~ ~~12.22.2.3(v)~~;
  - Necessary farm buildings approved (location and materials) by the Design Review Board
- ~~(b) Motorised vehicles;~~
- (eb) Bikes, except on marked and surveyed tracks;
- (ec) **Public** access during periods that the area is closed for grazing.

- x. **Parking** of vehicles and machinery in Activity Areas ~~6b, 6c~~ and 7 ~~during and/or after construction in these areas, except parking associated with a gondola.~~

## 12.22.43 Non-notification of Applications

~~Any application for a resource consent for the following matters may be considered without the need to obtain a written approval of affected persons and need not be notified in accordance with Section 93 of the Act, unless the Council considers special circumstances exist in relation to any such application:~~

Any application for resource consent for the following matters shall not require the written consent of other persons and shall not be notified or limited notified:

- (i) All applications for **Controlled** Activities;
- (ii) Applications for the exercise of Council's discretion in respect of the following site standards:
  - Earthworks
  - Outdoor Living Space
  - Village Green square / public open space area in Activity Area 1a
  - Bus shelters
  - Minimum Gross Floor Area
  - Service Areas and Access

## 12.22.54 Standards

## 12.22.54.1 Site Standards

### i. Village Green square / public open space area in Activity Area 1a

- (a) Within Activity Area 1(a), ~~every building with road frontage adjacent to the Village Green (Activity Area 6a) shall be built up to the street boundary along the full frontage of the site, except:~~
- ~~— where a pedestrian linkage is provided with a maximum width of 6.2m; and~~
  - ~~— the building may be set back up to 2m from the front boundary within 8m of any building corner.~~

~~This rule shall not preclude the provision of recessed entrances within any façade to a depth of 0.75m. a village square / public open space area shall be provided as a focal point to the Village. The village square / public open space area shall adjoin:~~

- Activity Area 6b to the north
- Commercial activities (including food and beverage) at ground floor level and/or road to the east, south and west.

The location, area, and design of the village square / public open space area shall be determined and assessed at the time the building(s) within Activity Area 1a are consented pursuant to Rule 12.22.2.2(iv).

### ii. Setbacks from Roads and Secondary Rear Access Lanes

- (a) Within Activity Area 1a all buildings shall be set back a minimum of 1m from the main access ~~through route B (as road~~ depicted on ~~the Mount Cardrona Station Special Zone Structure Plan A).~~

Comment [DCL7]: 14/12 full stops added to clauses (ix) and (x)

# MOUNT CARDRONA STATION SPECIAL ZONE

12

- (b) Within Activity Areas 1b and 2a all buildings shall be set back a minimum of 1m and a maximum of 3m from the road boundary.

Except:

~~The minimum setback from the main access/through route B (as depicted on the Mount Cardrona Station Special Zone Structure Plan A) for buildings within Activity Area 1b and 2a shall be 1 metre.~~

- (c) Within Activity Areas 2b and 3 all buildings shall be set back a minimum of 2m and a maximum of 4m from the road boundary.
- (d) Within Activity Area 4 the minimum setback from road boundaries of any building shall be 4.5m.
- (e) Within Activity Areas 2, 3 and 4 all garages and carports must be set back at least 1 metre from the front façade of the residential unit (i.e. the façade that faces the road).
- (f) Setbacks from secondary rear access lanes:  
Where the site has access to a secondary rear access lane, all residential units and secondary units shall be set back at least 2 metres from the rear lane boundary. There shall be no setback requirements from this rear lane for garages and accessory buildings.
- (g) Setback from Cardrona Valley Road  
Within Activity Area 8a all buildings shall be set back at least 10m from the boundary of the Cardrona Valley Road.

### iii. Setbacks from Internal Boundaries- Activity Areas 1, 2, 3, 4

- (a) There shall be no internal setback requirements within Activity Areas 1 and 2a.
- (b) Within Activity Area 2b there shall be one internal setback of 1m.

- (c) Within Activity Area 3, all buildings shall be set back at least 3.5m from the rear boundary, and at least 2m from all other internal boundaries.
- (d) Within Activity Area 4 all buildings shall be set back at least 4m from all internal boundaries.
- (e) Accessory buildings for residential activities (other than those used for the housing of animals) may be located within the setback distances from internal boundaries, where the total length of the walls of accessory buildings within the setback does not exceed 7.5m in length and there are no windows or openings, other than for carports, along any walls within 2m of an internal boundary.
- (f) Within Activity Areas 1, 2 and 3 no setback is required from an internal boundary where buildings share a common wall on that internal boundary.
- (g) Setbacks from Farm Yard Car Parks:  
Where the site has access to a farm yard car park, all residential units and secondary units shall be set back at least 2 metres from the boundary of the farm yard car park. There shall be no setback requirements from the farm yard car park for garages and accessory buildings.

### iv.

#### Outdoor Living Space

The following provision shall be made for outdoor living space [\[note: the requirements below do not apply to hotel guest units\]](#)

- (a) The minimum provision of outdoor living space for each residential unit and secondary unit contained within the net area of the site shall be:
- (i) Activity Area 1  
5m<sup>2</sup> contained in one area with a minimum dimension of 2m.

# MOUNT CARDRONA STATION SPECIAL ZONE

# 12

## (ii) Activity Area 2a

- Residential unit: 20m<sup>2</sup> contained in one area with a minimum dimension of 3.5m.
- Secondary unit: 5m<sup>2</sup> contained in one area with a minimum dimension of 2m.
- Above ground residential unit: 8m<sup>2</sup> balcony with minimum dimension of 2m.

## (iii) Activity Area 2b

- Residential unit: 36m<sup>2</sup> contained in one area with a minimum dimension of 3.5m.
- Secondary unit: 5m<sup>2</sup> contained in one area with a minimum dimension of 2m.

## (iv) Activity Area 3

- Residential unit: 36m<sup>2</sup> contained in one area at the ground floor level, with a minimum dimension of 6m.
- Secondary unit: 5m<sup>2</sup> contained in one area with a minimum dimension of 3.5m.

- (b) The outdoor living space shall be readily accessible from a living area.
- (c) No outdoor living space shall be occupied by any building.

## v. Building Height

The maximum building height within each Activity Area shall be:

Activity Area	Maximum Height
1	12m*
2	8m

\* Except for the single landmark building in Activity Area 1a, provided for by [Rule 12.22.5.4.1 \(xiv xiii\)](#), which shall have a maximum height of 24m

## vi. Stud Height

Within that area of Activity Area 1a that fronts the Village [Green square / public open space area](#), any building or part of a building within 6 metres of the front façade shall have a minimum ground floor stud height of 3.9 metres measured from floor to floor.

## vii. Boundary Fencing

The maximum height of any [Boundary Fencing](#) shall be:

- (i) Road [Boundary](#): 1.2m in height;
- (ii) Side yard boundaries: Between the road boundary and a point 1 metre behind the front façade of the dwelling: 1.2m in height;
- (iii) All other boundaries: 1.8m in height.

### Except:

Boundary fencing located between a private allotment and Activity Area 6 or 7 shall have a maximum height of 1.2m.

## viii. Bus Shelters within Activity Area 6a

Bus [Shelters](#) shall have dimensions no greater than 7.2m x1.8m.

## ix. Minimum Gross Floor Area – Residential Units (excluding secondary units) within Activity Areas 1, 2, 3 and 4 [\[note: the requirements below do not apply to hotel guest units\]](#)

Number of bedrooms	Minimum Gross Floor Area (square metres) (including above ground outdoor decking)
<a href="#">Studio units</a>	40
1 <a href="#">(including studio units)</a>	50
2	75 65
3+	90
4	115

## x. Service Areas and Access – Activity Area 1



# MOUNT CARDRONA STATION SPECIAL ZONE

# 12

- (a) Any storage or servicing areas shall be contained within the building or accessed from a service lane at the rear of the property.

## xi. Earthworks

The following limitations apply to all earthworks (as defined in this Plan), except for:

- earthworks associated with a subdivision that has both resource consent and engineering approval, and
- earthworks for the purposes of activities listed in [Controlled Activity Rule 12.22.32.2\(iii\)](#)

### 1. Earthworks

- (a) The total volume of earthworks does not exceed **200m<sup>3</sup>** per site (within a 12 month period). For clarification of “volume”, see interpretative diagram 5.
- (b) The maximum area of bare soil exposed from any earthworks where the average depth is greater than 0.5m shall not exceed **400m<sup>2</sup>** in area within that site (within a 12 month period).
- (c) Where any earthworks are undertaken within 7m of a Water body the total volume shall not exceed **20m<sup>3</sup>** (notwithstanding provision 17.2.2).
- (d) No earthworks shall:
- (i) expose any groundwater aquifer;
  - (ii) cause artificial drainage of any groundwater aquifer;
  - (iii) cause temporary ponding of any surface water.

### 2. Height of cut and fill and slope

- (a) The vertical height of any cut or fill shall not be greater than the distance of the top of the cut or the toe of the fill from the site boundary (see interpretative diagram 6). Except where

the cut or fill is retained, in which case it may be located up to the boundary, if less or equal to 0.5m in height.

- (b) The maximum height of any cut shall not exceed 2.4 metres.

- (c) The maximum height of any fill shall not exceed 2 metres.

### 3. Environmental Protection Measures

- (a) Where vegetation clearance associated with earthworks results in areas of exposed soil, these areas shall be revegetated within 12 months of the completion of the operations.

- (b) Any person carrying out earthworks shall:

- (i) Implement erosion and sediment control measures to avoid soil erosion or any sediment entering any water body. Refer to the Queenstown Lakes District earthworks guideline to assist in the achievement of this standard.
- (ii) Ensure that any material associated with the earthworks activity is not positioned on a site within 7m of a water body or where it may dam or divert or contaminate water.

- (c) Any person carrying out earthworks shall implement appropriate dust control measures to avoid nuisance effects of dust beyond the boundary of the site. Refer to the Queenstown Lakes District earthworks guideline to assist in the achievement of this standard.

## xii. Buildings within Activity Area 8a

No building within Activity Area 8a shall have a gross floor area of greater than 80m<sup>2</sup>.

## ~~xiii. Commercial Activities in Activity Area 1b~~

# MOUNT CARDRONA STATION SPECIAL ZONE

12

~~No commercial activities shall occur in Activity Area 1b until such time as at least 65% of the ground level of Activity Area 1a is built and occupied by commercial activities.~~

## xivj. Landmark Building in Activity Area 1a

In Activity Area 1a, one building only may comprise, among one or more design components, a landmark design component. The landmark design component shall not exceed the following dimensions:

- Maximum dimension of width or length: 8 metres
- Maximum width x length: 50m<sup>2</sup>

The building containing the landmark design component shall abut or be adjacent to the Village ~~Green square / public open space area.~~

## 12.22.54.2 Zone Standards

- i. All subdivision, use and development shall be undertaken in general accordance with ~~the Mount Cardrona Station Special Zone Structure Plans A – D.~~ except that:

- a) The intersection of Cardrona Valley Road and the Access Road, and the intersection of the Cardrona Ski Field Access Road and the Ski Field Link Road, may be moved up to 25 metres in any direction in order to enable safe and efficient functioning of those intersections.
- b) The roading design shall show a minimum separation distance of 25m between the Access Road / Cardrona Valley Road intersection and the Tuohy's Gully Road / Cardrona Valley Road intersection.

## ii. Building Restriction Line

- (a) ~~No building shall be located between the Building Restriction Line and the Zone boundary (as depicted on Structure Plan A).~~

~~(b)~~ **No building** shall be located between the Building Restriction Line- Maximum height 4.5m (as depicted on Structure Plan B) and the Zone boundary (as depicted on Structure Plan A).

~~(c)~~**(b)** **No building** shall be located within the Mitigation Bund- No Build as depicted on Structure Plans A and B.

## iii. Building Height

Activity Area	Maximum Height
<del>1a, 1b</del>	15m
<del>2a, 2b</del>	10m
3	7m
<del>3a and 3b</del>	<del>5.5m</del>
4	5.5m
5a (woolshed)	6m
5b (homestead)	8m
6a	4m
8a, 9	7m
<del>8c</del>	<del>4.5m</del>

### Except:

- (a) Within Activity Area 1a a maximum building height of 24m for the single landmark building element that abuts or is adjacent to the Village ~~Green square / public open space area.~~
- (b) Within Activity Area 1b **maximum** building heights shall be in accordance with the Mount Cardrona Station Structure Plan B "**Village Height Building** Restriction Lines", such that:
- (i) Any building or parts of a building located between the 'Building Restriction Line- Maximum Height 4.5m' and the 'Building Restriction Line- Maximum Height ~~6.5m~~ 6.5m (as depicted on Structure Plan B)' shall have a maximum height of 4.5m.

# MOUNT CARDRONA STATION SPECIAL ZONE

# 12

(ii) Any building or parts of a building located between the 'Building Restriction Line- Maximum Height 5m' and the 'Building Restriction Line- Maximum Height 6m' (as depicted on Structure Plan B) shall have a maximum height of 5m.

(ii) (iii) Any building or parts of a building located between the 'Building Restriction Line- Maximum Height 6m' and the 'Building Restriction Line- Maximum Height 8m' (as depicted on Structure Plan B) shall have a maximum height of 6m.

(iv) Any building or parts of a building located between the 'Building Restriction Line- Maximum Height 7m' and the 'Building Restriction Line- Maximum Height 8m' (as depicted on Structure Plan B) shall have a maximum height of 7m.

(iii) (v) Any building or parts of a building located between the 'Building Restriction Line- Maximum Height 8m' and the 'Building Restriction Line- Maximum Height 10m' (as depicted on Structure Plan B) shall have a maximum height of 8m.

(vi) Any building or parts of a building located between the 'Building Restriction Line- Maximum Height 9m' and the 'Building Restriction Line- Maximum Height 10m' (as depicted on Structure Plan B) shall have a maximum height of 9m.

(iv) (vii) Any building or parts of a building located between the 'Building Restriction Line- Maximum Height 10m' and the 'Building Restriction Line- Maximum Height 12m' (as depicted on Structure Plan B) shall have a maximum height of 10m.

(viii) Any building or parts of a building located between the 'Building Restriction Line- Maximum Height 11m' and the 'Building Restriction Line- Maximum Height 12m' (as

depicted on Structure Plan B) shall have a maximum height of 11m.

(c) Within Activity Area 3a

(i) Any building or part of a building located within a site adjacent to the 'Building Restriction Line- Maximum Height 4.5m' (as depicted on the Mount Cardrona Station Special Zone Structure Plan) shall have a maximum height of 4.5m.

(c) The maximum height for Activity Area 6 does not apply to pylons and other structures associated with a gondola in activity areas 6a and 6b.

## iv. Building Coverage – all buildings

The maximum building coverage for all activities on any site shall be:

Activity Area	% site coverage	% site coverage - dwelling and secondary unit
1a	95%	N/A
1b	80% 95%	N/A
2a	65% 75%	75%
2b	80%	
3	45%	55%
4	35% 40% except that where the site is greater than 4000m <sup>2</sup> 800m <sup>2</sup> in size, the maximum site coverage shall be 35% 40% or 400m <sup>2</sup> , whichever is the lesser.	N/A
5a (woolshed)	40%	N/A
5b (homestead)	30%	N/A

# MOUNT CARDRONA STATION SPECIAL ZONE

12

## v. Noise Limits

- (a) Activity Area 1  
Activities **located within Activity Area 1** shall be so conducted that the following noise limits are not exceeded at any point within the boundary of any other site within Activity Area 1:
- daytime (0800 - 2200 hrs) 60dBA L10
  - night time (2200 - 0800 hrs) 50dBA L10 and 70dBA Lmax
- (b) Activity Areas 2, 3, **and 4 and 5**  
Activities located within Activity Areas 2, 3, **and 4 and 5** shall be so conducted that the following noise limits are not exceeded at any point within the boundary of any other site within Activity Areas 2, 3, **and 4 and 5**
- Daytime 0800- 2000 hours 50dBA L<sub>10</sub>  
Night-time 2000- 0800 hours 40dBA L<sub>10</sub> and 70dBAL<sub>max</sub>
- (c) Noise levels shall be measured and assessed in accordance with NZS 6801:1991 and NZS6082:1991.**
- (c) Activities conducted in adjoining Activity Areas shall not exceed Activity Areas 2, 3, and 4 and 5 noise limits at any point within the boundary of any site within Activity Areas 2, 3, and 4 and 5.**
- (d) Noise levels shall be measured and assessed in accordance with NZS 6801:1991 and NZS6082:1991.**

## vi. Educational and Community Precinct

- ~~(i) Buildings constructed within Activity Area 3b shall be for the purpose of educational facilities or community activities only.~~

~~(ii) If alternative land for these facilities is zoned or designated in the existing Cardrona Village or on the valley floor, clause (i) shall expire, and Activity Area 3b shall be deemed to be zoned Activity Area 3a.~~

## vii. Walkways

~~Until such time as the walkway along the eastern boundary of Activity Areas 1, 3a, 3b has been constructed, no buildings shall be erected within Activity Area 3a.~~

## viii. Mitigation Earthworks and Planting

No building shall be erected within Activity Areas ~~1b, 3a and 3b~~ or in the Southern Neighbourhood (as shown on Structure Plan A) prior to the Mitigation Earthworks and Planting Plan (MEPP) (Structure Plan D) being approved ~~and implemented~~ pursuant to ~~Controlled Activity Rule 12.22.32.2(v) and implemented~~. Mitigation planting area M4 (as shown on Structure Plan D) shall be planted at commencement of development occurring on-site. For the areas of M4 at higher elevations (adjacent to Activity Area 4) the mitigation shall comprise earth mounding with native grasses, low tussocks and shrub species.

Prior to the commencement of development occurring on-site, the pines species in mitigation planting area M5 (as shown on Structure Plan D) shall be removed and the area replanted in accordance with the Mount Cardrona Station Design Guidelines 2017.

Upon approval of the MEPP under Rule 12.22. ~~32.2(v)~~ implementation shall commence within the first available planting season.

## ~~ix~~ viii. Commercial Activities in Activity Area 1a

Within Activity Area 1a the maximum combined total gross floor area of the following activities is restricted to 3000m<sup>2</sup>:

Comment [DCL8]: 13/12 comma deleted

Comment [DCL9]: 13/12 full stops added clauses vii. viii. ix. x. and xi.

# MOUNT CARDRONA STATION SPECIAL ZONE

# 12

- Bars
- Licensed Premises
- Restaurants
- Retail sales / Retail / Retailing
- Taverns

Provided that:

- this rule does not apply to any of the activities listed above if those activities are ancillary to and located in the same premises as any visitor accommodation operation;
- this rule does not apply to any temporary activity as defined in this District Plan;
- this rule shall cease to have effect on the date 15 years following the date that the Mount Cardrona Station Special Zone becomes operative 8 December 2026.
- For the purpose of this rule gross floor area excludes any areas for access, car parking and loading.

## **xviii.** Maximum number of units within the MCSSZ Zone

The number of residential units (excluding secondary units) and visitor accommodation units within the MCSSZ Zone shall not exceed 1000.

For the purposes of this rule a residential or visitor accommodation unit shall have a GFA greater than 50m<sup>2</sup>. In respect of buildings with multiple units of less than 50m<sup>2</sup>, the number of units will be calculated as the sum total GFA of all units with an individual GFA of less than 50m<sup>2</sup>, divided by 50.

## **ix.** Protection of stream bed and riparian margins in Homestead Gully – Activity Area 7**b**

No development shall occur in the zone until the a Homestead Gully Management Plan for the M6 Homestead Gully (as shown on Structure Plan D) Management Plan has been adopted prepared by

the landowner and approved by the Council and complied with. The purpose, features and implementation of the Homestead Gully Management Plan are set out in **Appendix A** to this Zone.

## **x.iii** Protection of water races in Activity 7**b** and Chaff Storage Platform in Activity Area 9

Prior to the commencement of development occurring on-site, the landowner shall be responsible for preparing and submitting to the Council for its approval a Management Plan for the water races and their margins and the chaff storage platform. The Management Plan will set out the on-going care and protection of the water races and their margins, including fencing and the planting of the downhill side of the water races in Chionochloa ecosystem species, and having regard to the management recommendations set out in the report Mount Cardrona Station Addendum November 2016 (Arch Hill Heritage Report No. 165).

The landowner shall also fill in any breaches in the water races except for drainage to the open space areas in Activity Area 6.

The management plan will also set out the on-going care and protection of the chaff storage platform, and how this feature will be incorporated into the golf course as a feature of historical interest.

The Management Plan shall be complied with on an ongoing basis.

## **xi.** Buildings within Activity Area 8**c**

The total combined gross floor area of all buildings within Activity Area 8c shall not exceed 400m<sup>2</sup>.

## **12.22.65** Assessment Matters

- Controlled and Discretionary Activities - Educational Facilities, Community Activities, Visitor Accommodation in Activity Areas 3 and 4, Health and Day Care Facilities, Commercial Recreation Activities in Activity Area 5**

# MOUNT CARDRONA STATION SPECIAL ZONE

12

The extent to which:

- (a) The activity is compatible with the amenity values of the surrounding environment, considering:
  - The visual amenity of the street, neighbouring properties and open space;
  - Hours of operation;
  - The proximity of outdoor facilities to neighbours and potential noise effects;
  - [Access to open space areas for education facilities](#);
  - The ability to landscape and or mitigate adverse visual effects.
- (b) The location and design of vehicle access and loading areas is such that it ensures safe and efficient movement of pedestrians and vehicles;
- (c) Outdoor storage areas do not have an adverse effect on the visual amenity of the surrounding area, and are screened from public view.

## ii. Controlled Activity- Buildings within Activity Areas [1a, 1b](#) and [5a](#)

In considering applications for buildings within Activity Areas 1 and [5a](#), the Council shall take into account the Mount Cardrona Station Design Guidelines ([20082017](#)), advice of the Design Review Board, and the extent to which:

- (a) The building has been considered as part of the wider environment in terms of how it reflects its location within the Village and the location of the open spaces it may face;
- (b) Views to the surrounding mountains have been considered in the design of the building;
- (c) The building design provides visual interest through articulation and variation;

- (d) The ground and first floor facades of the building establish a strong relationship to pedestrians, and the first floor appears accessible;
- (e) The building design is sympathetic to the character of the Village; having regard to:
  - materials
  - glazing treatment
  - vertical and horizontal emphasis
  - Colours
- (f) Proposed landscaping is consistent with the Mount Cardrona Station Design Guidelines ([20082017](#)), utilising plant species that reflect the surrounding environment, are drought tolerant and reflect the character of the Zone.
- (g) Car parking is unobtrusive and is consistent with the Mount Cardrona Station Design Guidelines ([20082017](#))
- (h) The design of the single landmark building reflects its function as a central point within the wider MCS Village and a key node within the village [precinct](#).

## (i) [In Activity Area 1a:](#)

- [Buildings are designed to maximise outlook towards nearby trees and greens within Activity Area 9;](#)
- [Buildings adjacent to the village square / public open space area are designed to address and provide an active interface with the village square / public open space area, taking into account the matters in 12.22.5\(xii\) below.](#)

## iii. Controlled Activity- Mitigation Earthworks and Planting Plan

[In relation to Structure Plan D](#), ~~the~~ the extent to which:

- (a) The earthworks are consistent with Structure Plan D.

# MOUNT CARDRONA STATION SPECIAL ZONE

12

- (b) The proposed planting is consistent with the planting list provided within Schedule 1a of the Mount Cardrona Station Design Guidelines ([2008/2017](#)).
- (c) The planting and earthworks reduce the effect of buildings within Activity Areas 1b, ~~3a and 3b~~, particularly when viewed from dwellings accessed from the paper road on the eastern side of the Cardrona River.
- (d) The proposed planting uses plant species that are proven to grow locally.

#### iv. Controlled activity- buildings within Activity **Areas 8a and 9**

The extent to which:

- (a) The building and associated activities:
  - In Activity Area 8a, ~~Are~~ are consistent with the maintenance of Activity Area 8a as the access to the Cardrona Ski Field Area and do not adversely affect the functioning of the Cardrona Valley Road.
  - Are compatible with the amenity values of the surrounding environment;
  - ~~Do not adversely affect the functioning and amenity of the Cardrona Valley Road.~~
- (b) Landscaping, materials and colours ~~is~~ are used to soften the visual appearance of any buildings.

#### v. Controlled Activity- Visitor Accommodation within Activity Areas **1b and 2**

The extent to which:

- (a) The activity is compatible with the amenity values of the surrounding environment, considering:
  - Hours of operation associated with any premises licensed for the sale of liquor

- The proximity of outdoor facilities to neighbours and potential noise effects

- (b) The location and design of vehicle access and loading areas is such that it ensures safe and efficient movement of pedestrians and vehicles;
- (c) Outdoor storage areas do not have an adverse effect on the visual amenity of the surrounding area, and are screened from public view.

#### vi. Controlled Activity- Premises Licensed for the Sale of Liquor in Activity Area 1.

The extent to which:

- (a) The activity is compatible with the amenity values of the surrounding environment, considering:
  - Hours of operation
  - The proximity of outdoor facilities to neighbours and potential noise effects
  - The adequacy of screening between the activity and any surrounding visitor accommodation or residential activities
  - The character and scale of the activity.

#### vii. Discretionary Activity- Commercial Activities in Activity Areas 1b, 2, 3 and 5, and Commercial Recreational Activities in Activity Areas 2 and 3

- (a) The extent to which the activities are compatible with surrounding residential activities, by taking into account:
  - Potential effects on the amenity of the street, neighbouring properties and open space;
  - Hours of operation;
  - The proximity of outdoor facilities to neighbours and potential noise effects;
  - The ability to landscape and or mitigate adverse visual effects.

# MOUNT CARDRONA STATION SPECIAL ZONE

# 12

(b) In Activity Area 1b:

- The extent to which the commercial activity does not detract from the vibrancy and cohesion of Activity Area 1a;
- The extent to which the commercial activity contributes to the mix of activities already established within Activity Area 1a;
- The extent to which the commercial activity is required to locate in Activity Area 1b in terms of functional operating or servicing requirements.

viii. **Discretionary Activity- Access Roads in Activity Areas 6 and 7 and Car parking and access within in Activity Areas 6a and 7**

The extent to which:

- (a) The car parking and access is necessary in order to enable public access to the open space areas;
- (b) The effects from hard surfaces can be avoided through use of permeable material;
- (c) The car park and access areas are rural in character;
- (d) Landscaping is used to mitigate adverse effects;
- (e) Earthworks are minimised through appropriate site location and design.

ix. **Discretionary Controlled Activity- Buildings and Structures associated with the erection and maintenance of a gondola within Activity Areas 6a, 6b and 7**

Consideration includes, but will not be limited to, the extent to which:

- (a) Adverse visual effects can be mitigated through the use of appropriate colour, design and location;
- (b) The activity provides direct access from the Village ~~Precinct~~ to surrounding recreational activities the Cardrona Ski Area, and reduces the need for private vehicle use on the ski ~~field~~ area access road;

- (c) Comprehensive car parking facilities are provided that
  - are located where they are easily accessible from the Village ~~Precinct~~ Centre ~~to surrounding recreational activities;~~
  - are effectively landscaped with species appropriate to the site so that adverse visual effects are minimised;
  - Provide significant permeable surfaces in order to reduce potential stormwater run-off.

- (d) The provision of linkage bus services from surrounding areas have been incorporated into the proposal;

- (e) As far as practicable the integrity of the open space area through which the gondola extends is retained;

- (f) The path of the gondola is sensitively located to reduce its visual effect (with regard to skyline, ridgeline and prominent slope);

- (g) The path of the gondola has an effect on the ecological functioning of natural stream/ native ecosystems;

- (h) Safety has been incorporated into the design;

- (i) The structures and associated facilities are designed so that earthworks are minimised and do not adversely affect the historic water races.

x. **Discretionary Activity- Take off and landing of aircraft within Activity Area 5a**

- (a) The extent to which noise from aircraft would:
  - (i) Be compatible with the character of the surrounding area;
  - (ii) Adversely affect the pleasant use and enjoyment of the surrounding environment by residents and visitors;
  - (iii) Adversely affect the quality of the experience of people partaking in recreational and other activities.

Comment [DCL10]: 13/12 amended to reflect changes to wording of rule



# MOUNT CARDRONA STATION SPECIAL ZONE

# 12

- (b) The cumulative effect of a dispersed number of take off and landing sites;
- (c) Convenience to and efficient operation of existing airports.
- (d) The visual effect of the take off and landing of aircraft and associated activities;
- (e) The frequency and type of aircraft activities;

**xi. Discretionary activity- buildings and structures within Activity Areas 6a and 6b**

With respect to gas storage facilities and a recycling station, the extent to which:

- (a) The built form and structures and associated landscaping have been designed to avoid or mitigate any adverse effects on the visual amenity of public places or open space;
- (b) The building and structures are necessary for the functioning of the Zone;
- (c) The building and structures have been located where they can be absorbed into the landscape.

With respect to tennis courts, the extent to which:

- (a) The activity is compatible with the amenity values of the surrounding environment, particularly in relation to any noise and lighting;
- (b) The building and structures have been located where they can be absorbed into the landscape;
- (c) The location of the tennis courts adversely affects stormwater flow paths and stormwater management.

~~With respect to buildings located within the Indicative Education Precinct, the extent to which~~

- ~~(a) The building is necessary for the functioning of sports fields~~
- ~~(b) The building can not be accommodated within the neighbouring Activity Area 3b~~
- ~~(c) A significant buffer is retained between the edge of the development and the southern boundary of the Special Zone.~~
- ~~(d) The building is designed and located such that adverse effects on landscape values are avoided.~~

**xii. Site Standard- ~~Commercial Activity in Activity Area 1b~~ Village square / public open space in Activity Area 1a**

- ~~(a) The extent to which the commercial activity does not detract from the vibrancy and cohesion of Activity Area 1a;~~
- ~~(b) The extent to which the commercial activity contributes to the mix of activities already established within Activity Area 1a;~~
- ~~(c) The extent to which the commercial activity is required to locate in Activity Area 1b in terms of functional operating or servicing requirements.~~

Whether and the extent to which:

- (a) the location, size and design of the village square / public open space area will allow it to:
  - be easily accessible to pedestrians;
  - act as the focal point for the Village;
- (b) the eastern, southern and western edges are or can be activated by commercial activities or food and beverage activities (including outdoor seating);

Comment [DCL11]: 14/12 added "6" to reflect changes above (consistent referencing of sub-areas)

# MOUNT CARDRONA STATION SPECIAL ZONE

# 12

(c) the design incorporates soft and/or hard landscaping, sculpture, and furniture to encourage interest, usability and vitality.

(d) the outlook to the north across Activity Areas 6 and 9 is promoted;

## xiii. Site Standard- ~~Village Green and~~ Road Setbacks and Secondary Rear Access Lanes

- (a) The extent to which the intrusion into the front yard is necessary to enable more efficient, practical use of the remainder of the site and a layout that responds to the surrounding context;
- (b) The extent to which the building will detract from the coherence, openness and attractiveness of the site as viewed from the street and adjoining sites;
- (c) The ability to provide adequate opportunities for landscaping that can help mitigate the effects of the intrusion into the setback;
- (d) The ability to provide adequate on-site parking and manoeuvring for vehicles.

## xiv. Site Standard- Internal Setbacks

- (a) The extent to which the intrusion into the internal boundary is necessary to enable more efficient, practical use of the remainder of the site and a layout that responds to the surrounding context;
- (b) The extent of any potential adverse effects on adjoining sites from the proximity of the building, including reduced privacy, visual dominance and loss of access to sunlight;
- (c) The ability to provide adequate landscaping around the building.

## xv. Site Standard- Outdoor Living Space

- (a) The extent to which the reduction in outdoor living space and/or its location will adversely affect the ability of the site to provide for the outdoor living needs of likely future residents of the site;
- (b) Any alternative provision on, or in close proximity to, the site for outdoor living space to meet the needs of likely future residents;
- (c) The extent to which the reduction in outdoor living space or the lack of access to sunlight is compensated for by alternative space within buildings with access to reasonable sunlight and fresh air.

## xvi. Site Standard- Building Height

- (a) The extent to which the increased building height may:
  - be incompatible with the scale of the surrounding buildings and local character;
  - adversely affect properties within the vicinity;
  - overshadow adjoining sites and result in reduced sunlight.
- (b) Whether the effects of the increased height could be mitigated through site layout and increased setback distances;
- (c) Within Activity Area 1, whether the height intrusion
  - Helps define and give character to open spaces, squares, streets, paths and parks;
  - Helps provide variation in building height that contributes to the legibility, visual interest and character of the neighbourhood;
  - Is used in combination with other design considerations such as street and open space layout, site configuration, building form, façade articulation and roof form design;

Comment [DCL12]: 13/12 Fix punctuation

# MOUNT CARDRONA STATION SPECIAL ZONE

12

- Has taken into account the importance in framing important vistas or views.

## xvii. Site Standard- Stud height in Activity Area 1

- (a) The ability of the building to provide for a range of uses at the ground floor.

## xviii. Site Standard- Boundary Fencing

- (a) The extent to which the fence is consistent with the overall character of the Mount Cardrona Station Special Zone, and retains the relationship between the private and public realm.

## xix. Site Standard- Bus Shelters in Activity Area 6a

The extent to which:

- (a) The materials, colour and landscaping of the bus shelter is consistent with the character of the Zone;
- (b) Coach parking and turning areas are provided that are safe and efficient and are easily accessed from Cardrona Valley Road.

## xx. Site Standard- Minimum Gross Floor Area

- (a) The compatibility of the proposed buildings with the scale of other buildings in the surrounding area;
- (b) The ability to provide adequate on-site amenity [having regard to the proposed use of the building](#).

## xxi. Site Standard- Servicing and Access in Activity Area 1

- (a) The extent to which the pedestrian focus at the building frontage is retained;
- (b) The ability to minimize adverse effects of loading and access on the coherence and character of the street.

## xxii. Controlled Activity and Site Standard – Earthworks

### 1. Environmental Protection Measures

- (a) Whether and to what extent proposed sediment/erosion control techniques are adequate to ensure that sediment remains on-site.
- (b) Whether the earthworks will adversely affect stormwater and overland flows, and create adverse effects off-site.
- (c) Whether earthworks will be completed within a short period, reducing the duration of any adverse effects.
- (d) Where earthworks are proposed on a site with a gradient >18.5 degrees (1 in 3), whether a geotechnical report has been supplied to assess the stability of the earthworks.
- (e) Whether appropriate measures to control dust emissions are proposed.
- (f) Whether any groundwater is likely to be affected, and any mitigation measures are proposed to deal with any effects.

NB: Any activity affecting groundwater may require resource consent from the Otago Regional Council.

### 2. Effects on landscape and visual amenity values

- (a) Whether the scale and location of any cut and fill will adversely affect:
  - the visual quality and amenity values of the landscape;
  - the natural landform of any ridgeline or visually prominent areas;
  - the visual amenity values of surrounding sites
- (b) Whether the earthworks will take into account the sensitivity of the landscape.

# MOUNT CARDRONA STATION SPECIAL ZONE

12

(c) The potential for cumulative effects on the natural form of existing landscapes.

(d) The proposed rehabilitation of the site.

### 3. Effects on adjacent sites:

(a) Whether the earthworks will adversely affect the stability of neighbouring sites.

(b) Whether the earthworks will change surface drainage, and whether the adjoining land will be at a higher risk of inundation, or a raised water table.

(c) Whether cut, fill and retaining are done in accordance with engineering standards.

### 4. General amenity values

(a) Whether the removal of soil to or from the site will affect the surrounding roads, and neighbourhood through the deposition of sediment, particularly where access to the site is gained through residential areas.

(b) Whether the activity will generate noise, vibration and dust effects, which could detract from the amenity values of the surrounding area.

(c) Whether natural ground levels will be altered.

**(d) Whether the golf course construction will generally maintain the natural contours of the land**

### 5. Impacts on sites of cultural heritage value:

(a) Whether the subject land contains a recorded archaeological site, and whether the NZ Historic Places Trust has been notified.

**xxiii. Restricted Discretionary Activity – in Activity Area 8c: carparking; earthworks for carparking formation and visual avoidance or mitigation; and buildings that are for shuttle / ski area ticketing, bus shelters, ablution facilities and complementary ancillary commercial uses (limited to such as chain fitting services and coffee carts) and associated buildings.**

(a) Whether the carparking, associated buildings and activities are screened from view by mitigation earthworks and planting when viewed from:

- Activity Areas 1, 2, 3, 4, 5 and 6 of the Zone;
- the dwelling on Lot 6 DP 344432;
- the Cardrona Valley Road;

(b) In relation to the earthworks required, the extent to which the matters in 12.22.5(xxii) above are satisfied.

(c) Sealing of the carpark to an acceptable standard;

~~(d) The nature and scale of the complementary commercial uses and associated buildings.~~

~~(d) The extent to which the proposed uses and buildings are ancillary to and complementary with the primary car parking activity.~~

**xxiv. Discretionary activity – tennis courts in Activity Area 6:**

~~(a) Proximity of the courts to neighbouring properties and any adverse effects of noise and lighting on residential amenity.~~

~~(b) Whether the location of the tennis courts adversely affects stormwater flow paths and stormwater management.~~

Comment [DCL13]: Fixed punctuation in clauses (a) and (c)

# MOUNT CARDRONA STATION SPECIAL ZONE

# 12

xxiv. Discretionary activity – Rule 12.22.2.3.2(viii)(ix) – activities prior to subdivision of the site to accommodate that activity:

Comment [DCL14]: 14/12 full stop added

- (a) Future efficient subdivision and development is not compromised by inappropriately located development.
- (b) The proposal is supported by a geotechnical **natural** hazards assessment prepared by a suitably qualified professional engineer
- (c) Compliance with the Mount Cardrona Station Design Guidelines (2017)

# MOUNT CARDRONA STATION SPECIAL ZONE

12

## APPENDIX A – MITIGATION PLANTING AREA 6 (M6) HOMESTEAD GULLY – PREPARATION, APPROVAL AND IMPLEMENTATION OF THE HOMESTEAD GULLY MANAGEMENT PLAN (HGMP)

The HGMP applies to all of the land within Activity Area 7b located south of [Road A](#) (the [Ski Field Area](#) access road), north of [Road B](#) the ski area link road, and north of Activity Areas 1, 2, 3, and 4 and 9, as shown on Structure Plan A and Structure Plan D.

The landowner shall be responsible for preparing and submitting the HGMP to the Council for its approval. The HGMP will set out the plans and methods to achieve:

- (i) The long term protection and enhancement of the natural values of the Homestead Gully area including all wetland and stream areas, riparian margins and the gully walls;
- (ii) The progressive removal of all weed species;
- (iii) The control of animal pest species;
- (iv) Complete fencing of the gully from the grassy slope to the northeast, to prevent intrusion by farm stock;
- (v) The inclusion of pedestrian trails, including (but not limited to) a 2-2.5m wide trail along the northern side of Homestead Creek [as shown on Structure Plan A](#);
- (vi) In the floor of the Gully, the planting of indigenous species and at a density in general accordance with the following table:

Indigenous Plants for Ecological Plant Communities	Grid planting density – 1 plant per:
<i>Coprosma rugosa</i>	3.0m
<i>Halocarpus bidwillii</i> (bog pine)	4.0m
<i>Hebe salicifolia</i> (koromiko)	3.0m
<i>Olearia bullata</i> (tree daisy)	3.0m

<i>Olearia hectorii</i> (tree daisy)	4.0m
<i>Carex secta</i> (oio, nigger head)	1.5m
<i>Chionochloa conspicua</i> (bush tussock)	1.5m
<i>Phormium tenax</i> (swamp flax)	2.0m

- (vii) On the northern face of the Gully, the planting of indigenous beech-hardwood species in pockets around the existing shrubland areas, and pockets of indigenous grey shrublands on the upper part of the face..
- (viii) On the southern face of the Gully, the planting of small groups of indigenous grey shrubland species particularly in the shallow depressions/gullies.
- (ix) The ongoing maintenance of the indigenous planting in (vi), (vii) and (viii) above;
- (x) In the area above the groundwater seepage line on the higher slopes of the south side of the gully, to maintain an extended Matagouri/grey shrubland mix of species;
- (xi) Careful design of the edge of the gully area including of any retaining walls necessary at the boundary with Activity Area 1b, in respect of the visibility from other parts of the gully and the [Ski Field Area](#) access road.

The HGMP shall set out the methods for implementation to achieve the goals in (i) – (xi) above, including any staging proposed as development through the zone proceeds, and shall specify the various responsibilities for the implementation and ongoing maintenance of the works required.

Once approved, the HGMP shall be complied with on an ongoing basis.

**NOTE: Operative versions of Structure Plans A – D have been deleted. Proposed versions have been inserted as follows**

# MOUNT CARDRONA STATION SPECIAL ZONE

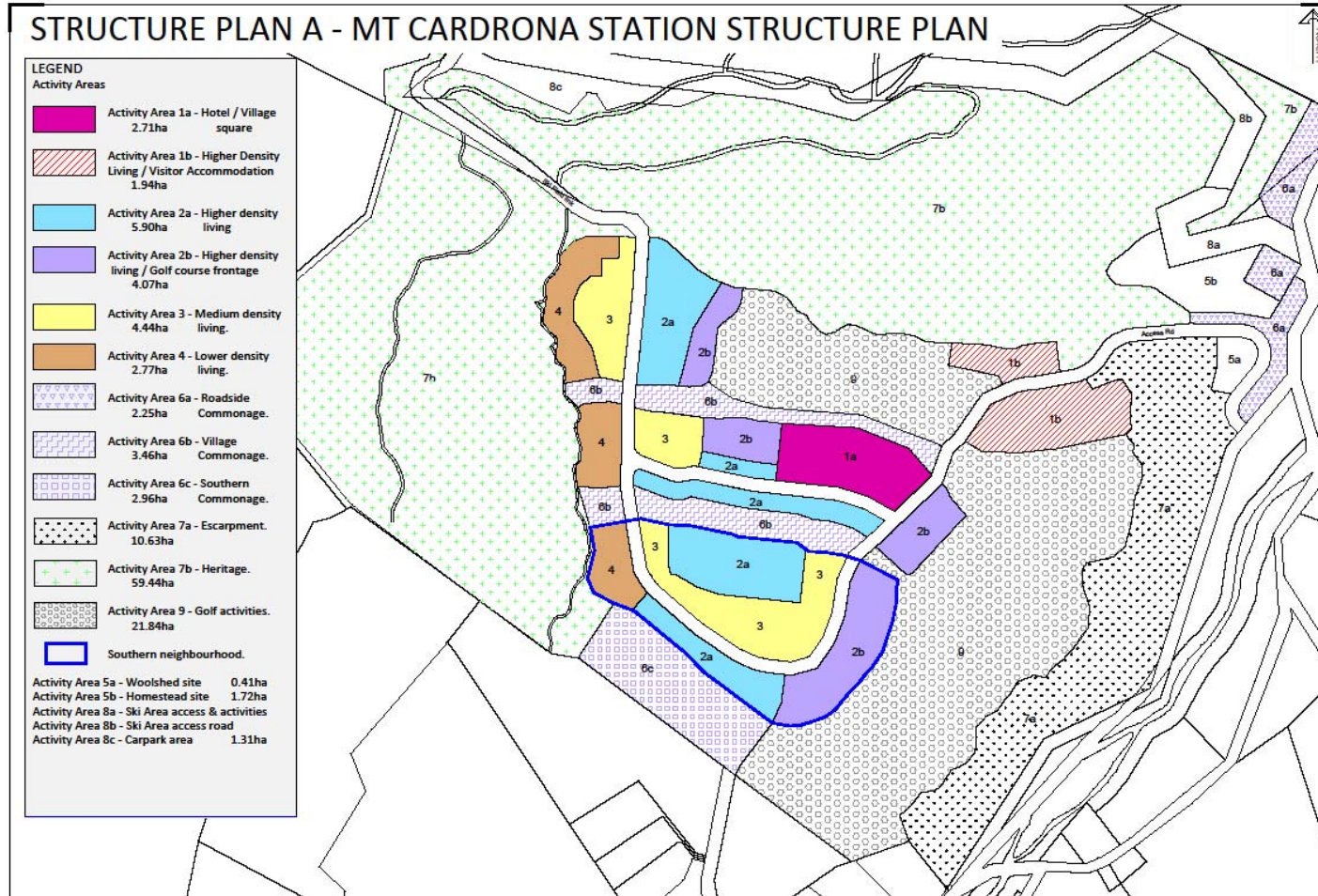

# MOUNT CARDRONA STATION SPECIAL ZONE

12

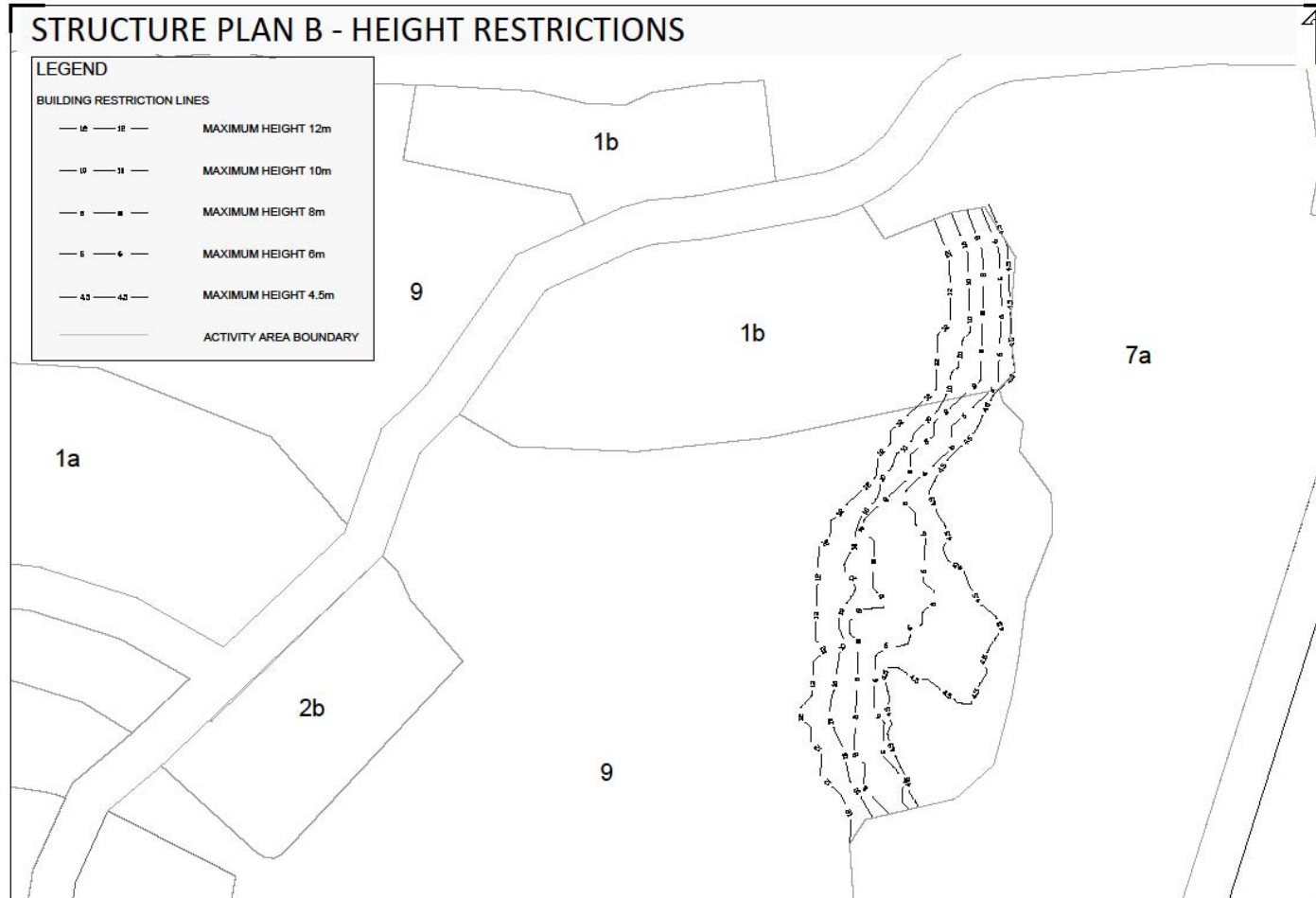



# MOUNT CARDRONA STATION SPECIAL ZONE

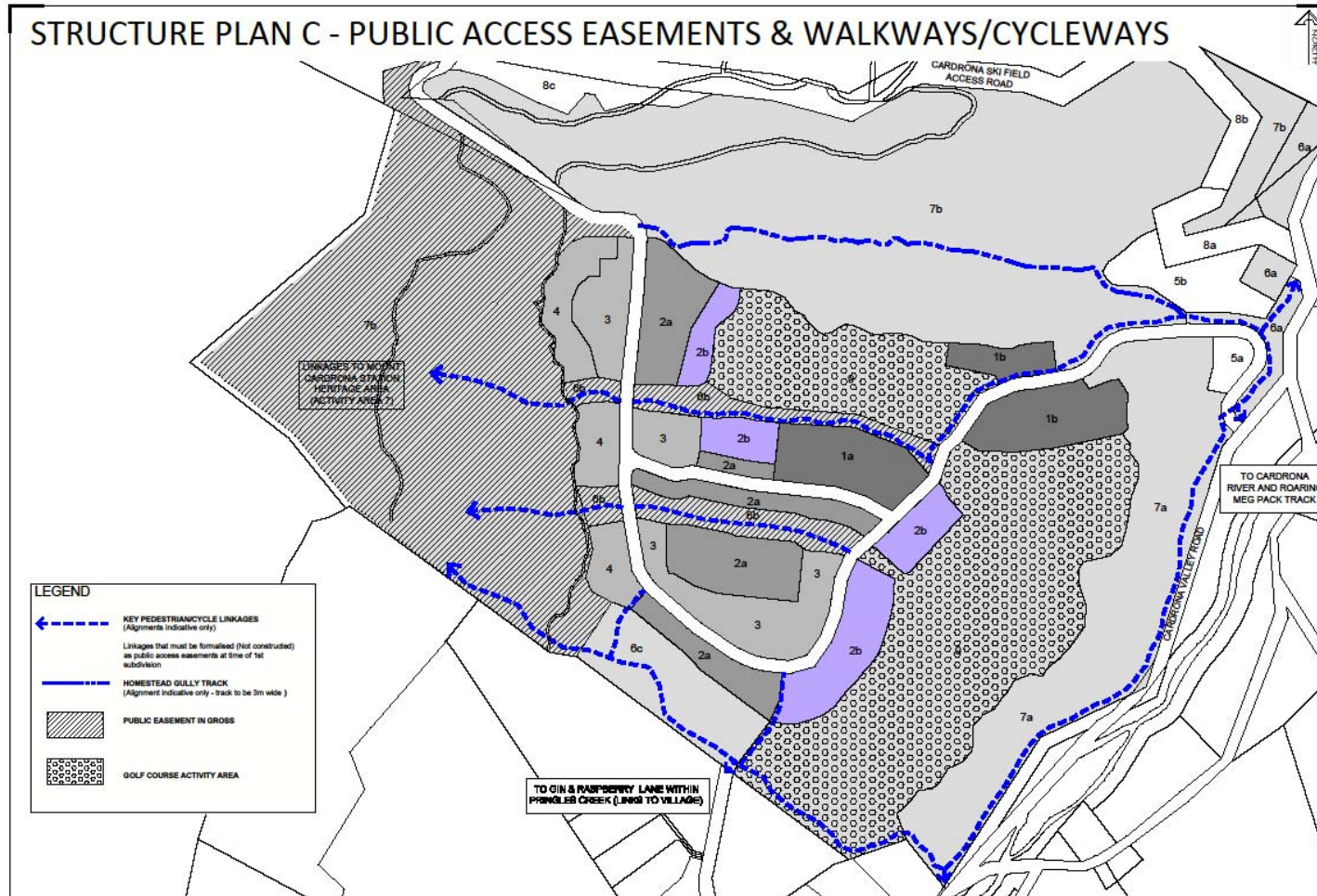

**Comment [DCL15]:** I have just picked up that this plan has removed the public easement in gross from AA6c. There is no assessment of this as far I can see in either the Requestor's s32 or the s42A report. I am not sure about the background to this. It could potentially limit access from Pringles Creek Road.

# MOUNT CARDRONA STATION SPECIAL ZONE

